

◆ Dimensions

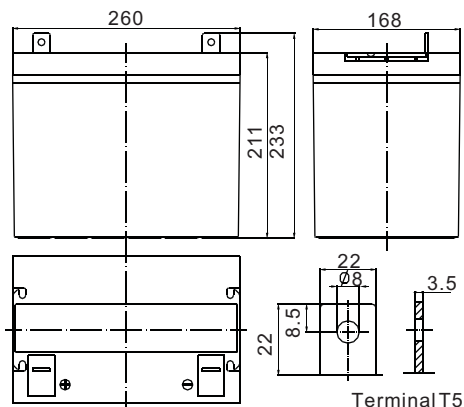

◆ Specifications

Nominal voltage		12 V
Capacity(10HR, 25°C)		60Ah
Dimension	Length	260mm (10.24inch)
	Width	168mm (6.61inch)
	Height	211mm (8.31inch)
	Total height	233mm (9.17inch)
Approx. weight		24.0kg (52.9lbs)
Internal resistance (Fully charged, 25°C)		Approx.5.5mΩ
Capacity affected by temperature (10HR)	40°C	102%
	25°C	100%
	0°C	85%
	-15°C	65%
Self-discharge (25°C)	3 month	Remaining capacity: 91%
	6 month	Remaining capacity: 82%
	12 month	Remaining capacity: 65%
Normal operating temperature		25°C ±3°C(77°F ±5°F)
Operating temperature range		-15°C ~ 50°C (5°F ~ 122°F)
Float charging voltage(25°C)		13.38 to 13.80V
Cyclic charging voltage(25°C)		14.40 to 15.00V
Maximum charging current		18A
Terminal material		Copper
Maximum discharge current		600A(5 sec.)

- ◆ Absorbent glass mat technology;
- ◆ Recognized by UL & CE;
- ◆ Flame retardant ABS container (UL94V-0/ 94V-2).

◆ Charging Characteristics(25°C)

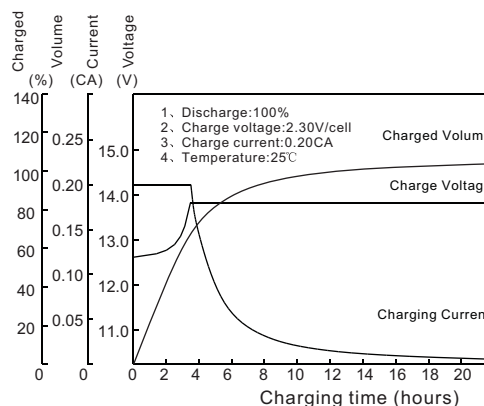

◆ Cycle Life(25°C)

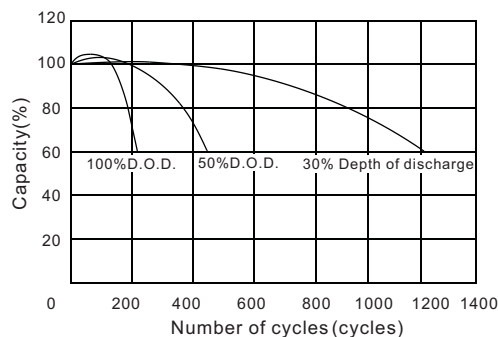

◆ Note: Floating life designed for 10 years at 20°C.

Constant Current Discharge Characteristics(A,25°C)

F.V/TIME	5min	10min	15min	30min	60min	3h	5h	10h	20h
9.60V	215	145	120	69.0	44.0	16.2	11.8	6.09	3.25
10.2V	204	138	115	66.2	42.2	16.0	11.6	6.04	3.22
10.8V	192	129	109	62.9	40.1	15.7	11.4	6.00	3.20

Constant Power Discharge Characteristics(Watt,25°C)

F.V/TIME	5min	10min	15min	30min	60min	3h	5h	10h	20h
9.60V	2258	1566	1318	774	502	191	139	72.7	39.0
10.2V	2145	1488	1265	743	482	188	137	72.1	38.6
10.8V	2016	1398	1202	706	457	184	135	71.6	38.4